

BR-GZ10 / HLDR

Keramické patice



● BR-GZ10



● HLDR-GZ10

● HLDR-R7S

● HLDR-GX5.3

● HLDR-G9

HLDR-GX5.3

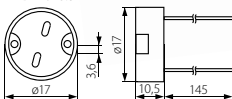

HLDR-GZ10

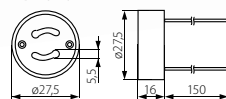

BR-GZ10

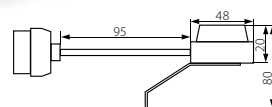
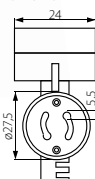

HLDR-R7S

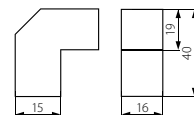

HLDR-G9

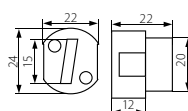

● těleso: keramika

Kanlux	Kanlux	EAN								DKC CZ bez DPH
BR-GZ10	72369	5905339723697	šedá	250V~	GU10/GZ10	15cm, 2 x 0,75mm ²	1/20/200		54	35 Kč
HLDR-GZ10	00402	5905339004024	šedá	250V~	GU10/GZ10	15cm, 2 x 0,75mm ²	1/50/1000		16	11 Kč
HLDR-R7S	00405	5905339004055	šedá	250V~	R7s	25cm, 2 x 0,75mm ²	-/10/500		21	9 Kč
HLDR-GX5.3	72109	5905339721099	šedá	24V	G4-GY6,35	15cm, 2 x 0,75mm ²	-/100/2000		6	8 Kč
HLDR-G9	08220	5905339082206	šedá	250V~	G9	15cm, 2 x 0,75mm ²	1/50/1000		16	17 Kč

- maximální přípustná teplota objímky u HLDR-GZ10, HLDR-R7S je 250°C, u HLDR-GX5.3, HLDR-G9 je 180°C
- maximální proud BR-GZ10, HLDR-GZ10, HLDR-G9 je 2A, u HLDR-R7S je 6A, u HLDR-GX5.3 je 5A, patice BR-GZ10 obsahuje konzolu

